

SELANDRA COMMUNITY HUB

FACILITY INFORMATION

2022



An integrated community facility for Clyde North

Selandra Community Hub, a welcoming and engaging facility that allows people to connect, belong, learn and play. Supporting Clyde North's growing community, the multi-use spaces and amenities aim to provide a vibrant and inclusive hub that supports programs and services for all genders, ages and cultures.

The hub aspires to:

- Be a place where people can build relationships and a community identity.
- Be a place where residents can meet and carry out activities.
- Be a place that strengthens the life of the community.
- Be a place where residents can access a range of activities, programs and services.
- Importantly, the hub co-locates community service organisation's to offer much needed services to the Clyde North community.

Selandra Community Hub Vision

A place that strengthens the life of the community, where people come together to connect, belong, learn and play.

Location

Located at 7-9 Selandra Boulevard, Clyde North, the dual level community facility is within a short distance from the shopping centre, local businesses, and park.

Floor Plan – Ground Level

Selandra Community Hub - Ground Level consists of a large foyer, community arts exhibition space, shared kitchenette, commercial kitchen, training room, two flexible multipurpose halls, a lounge room and adult changing room.

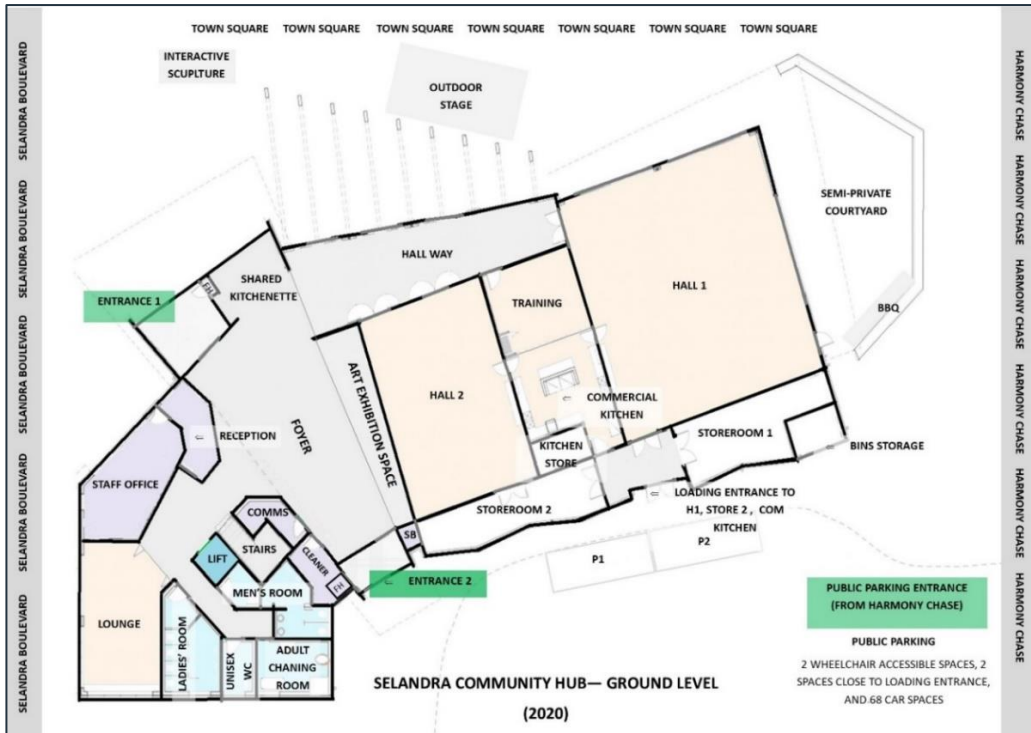

Floor Plan – Upper Level

Selandra Community Hub – Upper Level is a mezzanine overlooking the ground level foyer and community arts exhibition space consisting of two small meeting rooms that can be combined into one bigger space, two consulting rooms and shared kitchenette, a waiting area, and wheelchair accessible toilets.

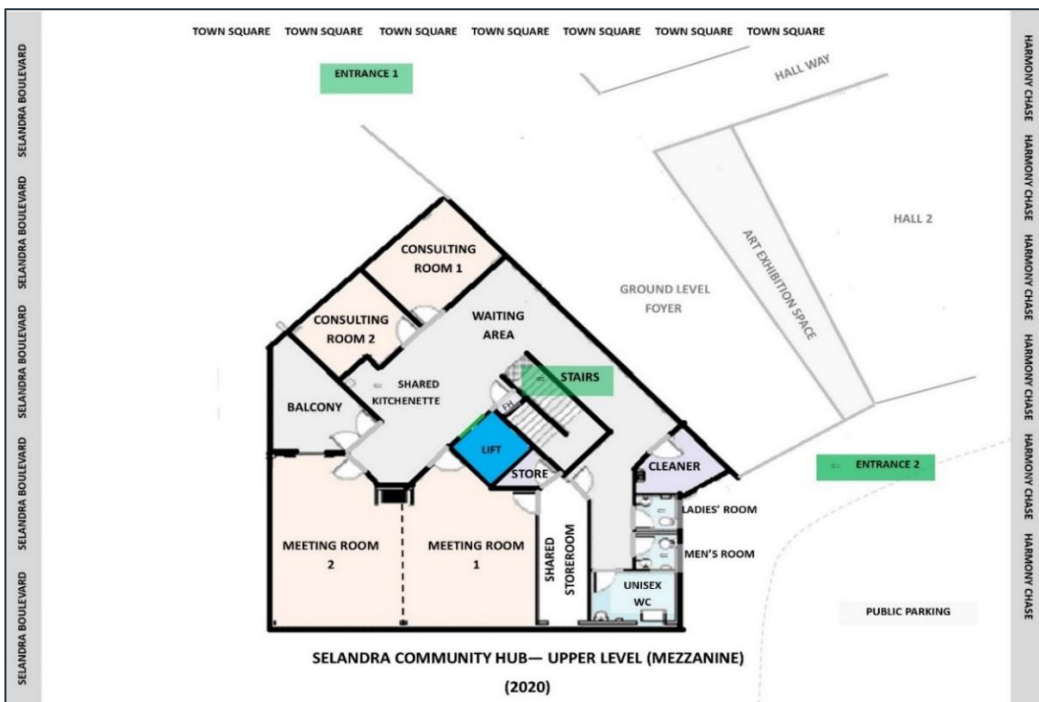

Rooms and Resources

Each room varies in size and in its capacity to deliver programs and activities. Your maximum capacity may vary depending on current restrictions and your seating style arrangement.

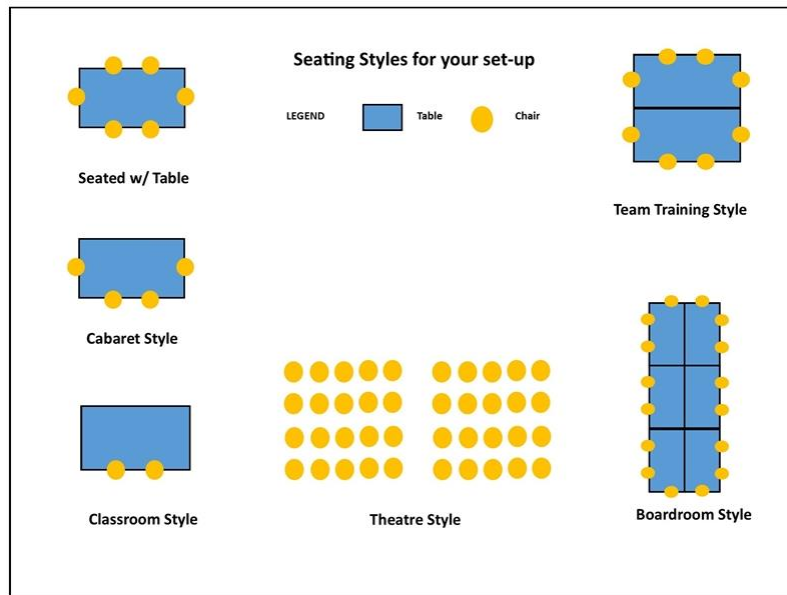

Room / Hall	Capacity	Features
<p>Hall 1 200 square metres</p> <p>The largest space in the Hub - this light-filled hall is perfect for community events and large meetings. Hall 1 boasts polished bamboo floors, natural light from three large glass sliding doors and four skylights. For your comfort, Hall 1 also has a private kitchenette adjoining the Kitchen servery window, and direct access to the full Commercial Kitchen. To further this space, the sliding glass doors open to access to the expansive courtyard area and BBQ.</p> <p>Hall 1 with our Commercial Kitchen is available to hire for Private Functions or Celebrations.</p>	<ul style="list-style-type: none"> Capacity as per 4sqm rule: 50 Capacity as per 2sqm: 100 Based on set-up or no restrictions: <ul style="list-style-type: none"> » 40 - Classroom style » 120 - Seated with tables or for private functions » 170 - Theatre Style 	<ul style="list-style-type: none"> Laser projector and audio support Kitchenette with tap for filtered and boiling water Direct access to Commercial Kitchen (Charges apply) Direct access to public courtyard with BBQ 20 rectangle trestle tables on wheels 120 chairs Two wireless handheld microphones (on request) 1 lapel microphone (on request) Portable Stage
<p>Hall 2 100 square metres</p> <p>The second largest space in the Hub, Hall 2 is ideal for medium to small gatherings. Hall 2 boasts beautiful bamboo floors and lots of natural light through the glass doors, windows and three skylights, which</p>	<ul style="list-style-type: none"> Capacity as per 4sqm rule: 25 Capacity as per 2sqm rule: 50 Based on set-up or no restrictions: <ul style="list-style-type: none"> » 20 - Classroom style » 60 - Seated with tables » 80 - Theatre Style 	<ul style="list-style-type: none"> Laser projector and audio support Kitchenette with tap for filtered and boiling water Direct access to Commercial Kitchen (Charges Apply) 10 rectangle trestle tables on wheels 60 chairs

<p>make this room versatile and flexible for a wide variety of use.</p>		<ul style="list-style-type: none"> ● Portable Stage (pending availability)
<p>Commercial kitchen 30 square metres A full commercial kitchen with 2 gas stoves, griddle tops, and ovens, this kitchen is perfect for training. Featuring stainless steel surfaces, a large commercial dishwasher, ample bench space, and access to all kitchen crockery and cutlery (need own cooking and serving equipment).</p> <p>Hall 1 with our Commercial Kitchen is available to hire for Private Functions or Celebrations.</p>	<ul style="list-style-type: none"> ● Capacity as per 4sqm rule: 6 ● Capacity as per 2sqm only: 8 ● No Restrictions: 10 	<ul style="list-style-type: none"> ● Access to all kitchen crockery and cutlery only. (additional equipment required must be brought in) ● Full access to all cooking areas.
<p>Training room 30 square metres Connected to the Commercial Kitchen, the Training Room can be hired for additional space when completing practical training or catering and can be closed off and hired as a stand-alone room, suitable for training, cooking classes, workshops, art classes and more.</p>	<ul style="list-style-type: none"> ● Capacity as per 4sqm rule: 7 ● Capacity as per 2sqm rule: 15 ● Based on set-up or no restrictions: <ul style="list-style-type: none"> » 10 - 12 Classroom style » 15 - Seated with tables » 15 - Theatre Style » 12 - Boardroom Style 	<ul style="list-style-type: none"> ● 4 rectangle trestle tables on wheels ● 15 chairs ● Digital Display
<p>Lounge Room 48 square metres Located on the ground floor, the Lounge is a multipurpose space that is great for small meetings and groups. The Lounge features carpeted floors and large windows that fill the room with natural light.</p>	<ul style="list-style-type: none"> ● Capacity as per 4sqm rule: 11 ● Capacity as per 2sqm rule: 20 ● Based on set-up or no restrictions: <ul style="list-style-type: none"> » 8-10 - Classroom style » 16 - Cabaret Style » 15 - Seated with tables » 20 - Theatre Style » 14 - Boardroom Style 	<ul style="list-style-type: none"> ● 4 rectangle trestle tables on wheels ● 15 chairs ● Permanent cushioned window seat ● Digital Display
<p>Consult room 1 13 square metres Consulting Room 1 is a space designed with a warm ambience suitable for counselling or small informal meetings.</p>	<ul style="list-style-type: none"> ● Capacity as per 4sqm rule: 3 ● Capacity as per 2sqm rule: 3 ● No restrictions: 5 (1 worker and 4 clients) 	<ul style="list-style-type: none"> ● 2-seater couch ● 2 cushion chairs ● Lamp ● Desk with a docking station connecting to double monitors and office chair

<p>Consult room 2 13 square metres</p> <p>Located on the first floor, Consulting Room 2 is a small flexible room ideal for small meetings, and personal business use. The rooms feature carpeted floors and large windows that fill the room with natural light, with direct access to the shared Kitchenette facilities, bathrooms, and lift access.</p> <p>Currently available afterhours from 5:30pm Monday-Friday or on Weekends.</p>	<ul style="list-style-type: none"> ● Capacity as per 4 sqm rule: 3 ● Capacity as per 2sqm rule: 3 ● No restrictions: 5 	<ul style="list-style-type: none"> ● 1 round table with 4 chairs for small meetings ● 2 Desks with a docking station or HDMI connection to a monitor and 2 office chairs
<p>Meeting Room 1 & 2 Combined 71 square metres</p> <p>Meeting Room 1 and 2's operable wall can be opened to combine both rooms that can accommodate more people and provide multi-use.</p>	<ul style="list-style-type: none"> ● Capacity as per 4sqm rule: 17 ● Capacity as per 2sqm rule: <ul style="list-style-type: none"> » 35 - Theatre style » 18-20 - Classroom style » 20 - Board Room Style ● Based on set-up or no restrictions: <ul style="list-style-type: none"> » 40 - Theatre Style » 18-20 - Classroom style » 20 - Boardroom Style 	<ul style="list-style-type: none"> ● 10 rectangle trestle tables on wheels ● 40 chairs ● Digital Display
<p>Meeting room 1 38 square metres</p> <p>Meeting Room 1, with ample tables and chairs available in the adjoined storeroom for easy access for your set up and pack down. Featuring a digital television for presentations, and within proximity to both the shared kitchenette and bathroom facilities on the first floor, this space is a perfect choice for small meetings and presentations.</p>	<ul style="list-style-type: none"> ● Capacity as per 4sqm rule: 9 ● Capacity as per 2sqm rule: 18 ● Based on set-up or no restrictions: <ul style="list-style-type: none"> » 10 - Classroom style » 12 - Board Room Style » 20 - Theatre Style 	<ul style="list-style-type: none"> ● Digital display ● 5 rectangle trestle tables on wheels ● 20 chairs ● Whiteboard wall
<p>Meeting room 2 33 square metres</p> <p>Shares a floor to ceiling dividing wall with Meeting Room 1. Meeting Room 2, have ample tables and chairs available, has direct access to the West-facing balcony and is located within proximity to both the shared kitchenette and bathroom facilities on the first floor.</p>	<ul style="list-style-type: none"> ● Capacity as per 4sqm rule: 8 ● Capacity as per 2sqm rule: 16 ● Based on set-up or no restrictions: <ul style="list-style-type: none"> » 10 - Classroom style » 12 - Board Room Style » 18 - Theatre Style 	<ul style="list-style-type: none"> ● Whiteboard Wall ● 5 rectangle trestle tables on wheels ● 18 chairs

The Community Hub also offers

- Large open reception and foyer area with casual seating, access to tea and coffee facilities – BYO cup encouraged.
- Access to Public Wi-fi
- Book Swap
- Lift access to the upper level.
- Fully accessible changing place room.
- Wheelchair accessibility to all areas.
- Environmentally sustainable design.
- Town square with abundant seating.
- Ample parking.

Contact the City of Casey:

Web: casey.vic.gov.au

Email: caseycc@casey.vic.gov.au

Phone: 03 9705 5200

Post: PO Box 1000, Narre Warren VIC 3805

NRS: 133 677 (for the deaf, hearing or speech impaired)

Customer Service Centres:

Narre Warren: Bunjil Place, Patrick Northeast Drive

Cranbourne: Cranbourne Park Shopping Centre

ABN: 43 320 295 742

